



FEATURES

- Lamp with high grade components & excellent Cool Day Light illumination
- Coolant, Water & dust proof hence suitable for wet & dry applications
- Energy Saver with IP 67 Grade Protection
- Heat resistant & shock proof & easily mountable either vertically or horizontally
- Ideal for Packaging, CNC & SPM Machines in Tool job Changing & Machining
- Stringently checked on various criterion of performance
- Modular design with Superior Finishing & tamperproof packaging
- Longer functional life & Cost Effective
- Widely used in automobile, Production & Electrical Engineering industries

SPECIFICATIONS

INPUT VOLTAGE	24V DC / 110V Or 230V AC
WATTAGE	9W
CONTROL GEAR	ONBOARD
CRI	82 typical
LUMINAIRE BODY	SMD LED STRIP
NO OF LED's	18
LED COLOUR	COOL WHITE
O/P POWER	9 W
O/P CURRENT	0.36 A
LUMENS	590 Lm, 6500K
LIGHT VIEWING ANGLE	120 °
DIAMETER	60 MM
FASTENING	END BRAKETS
PROTECTION GRADE	IP 65
WEIGHT	1.0 Kg approx without Control Gear
LED MAKE	EVERLIGHT / OSRAM
CABLE LENGTH	1.5 Mtrs for 24V DC & 3 Mtrs for 230V AC

ORDERING CODE

INTERNAL BALLAST MODEL

SMC -CNC -1 -1-I-L 24V DC 350

EXTERNAL BALLAST MODELS

SMC -CNC -1 -2-E -L 110V AC 350

SMC -CNC -1 -3-E -L 230 V AC 350

* Length in mm

DIMENSIONAL DRAWING

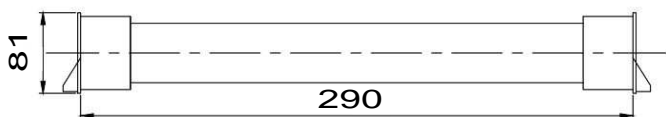
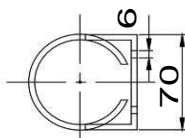
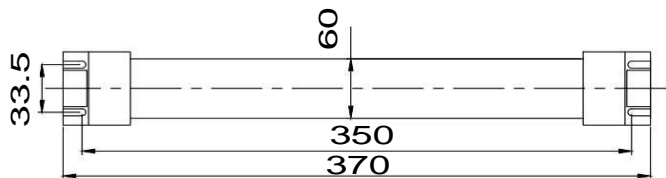

* Dimensions in mm

SURYA MANUFACTURING COMPANY

AN ISO 9001 - 2015 CERTIFIED MANUFACTURER