



### FEATURES

- . Lamp with high grade components & excellent Cool Day Light illumination
- . Coolant, Water & dust proof hence suitable for wet & dry applications
- . Energy Saver with IP 67 Grade Protection
- . Heat resistant & shock proof & easily mountable either vertically or horizontally
- . Ideal for Packaging, CNC & SPM Machines in Tool job Changing & Machining
- . Stringently checked on various criterion of performance
- . Modular design with Superior Finishing & tamperproof packaging
- . Longer functional life & Cost Effective
- . Widely used in automobile, Production & Electrical Engineering industries

### SPECIFICATIONS

<b>INPUT VOLTAGE</b>	24V AC/DC, 110 AC, 230 V AC
<b>WATTAGE</b>	18 WATTS - SINGLE TUBE - 2U
<b>CONTROL GEAR</b>	ELECTRONIC BALLAST FOR 24V AC/DC 110V AC & Cu BALLAST FOR 230V AC
<b>LUMENS</b>	1300 Lm, 6500K Cool Day Light
<b>LUMINAIRE BODY</b>	BOROSILICATE GLASS
<b>DIAMETER</b>	60 MM
<b>FASTENING</b>	END BRACKETS
<b>PROTECTION GRADE</b>	IP 67
<b>WEIGHT</b>	2.2 Kgs Approx without Control Gear
<b>REPLACEMENT TUBE</b>	18W/ -865 - 2G11 - 2Pin - 2U
<b>CABLE LENGTH</b>	1.5 Mtrs for 24V DC & 3 Mtrs for 230V AC

### ORDERING CODE

INTERNAL BALLAST MODELS		
SMC -CNC - 3-1-I	24V AC/DC	385
SMC -CNC - 3-2-I	110V AC	385
SMC -CNC - 3-3-I	230V AC	385
EXTERNAL BALLAST MODELS		
SMC -CNC - 3-1-E	24V AC/DC	350
SMC -CNC - 3-2-E	110V AC	350
SMC -CNC - 3-3-E	230V AC	350

\* Length in mm

### DIMENSIONAL DRAWING

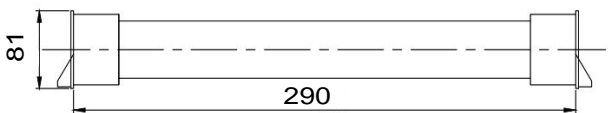
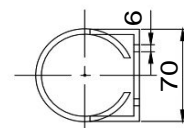
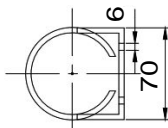
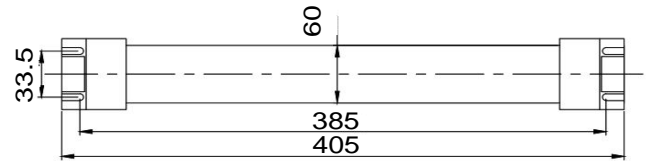
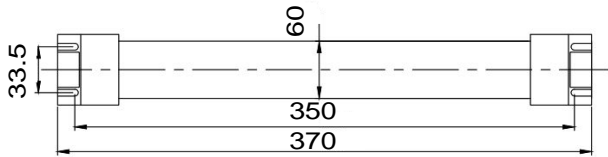

EXTERNAL BALLAST

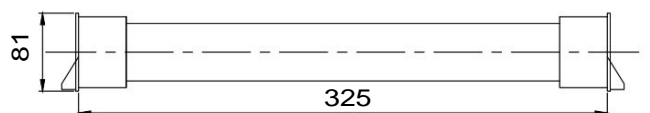

INTERNAL BALLAST

\* Dimensions in mm

**SURYA MANUFACTURING COMPANY**

AN ISO 9001 - 2015 CERTIFIED MANUFACTURER